

EWB Series

Wide Band Chokes

TRIGON
COMPONENTS



FEATURES

- The wide band choke cores mainly used in the PC boards to filters the EMI from the outsides.

APPLICATION

- Computer PC, Electronics products, etc.

ORDERING CODE

EWB **R6H** **HGB** **2.5**
(1) (2) (3) (4)

(1) Wide Band Chokes

(2) Hole: R6H, R8H

(3) Material:

(4) Number of Turns

Configurations:

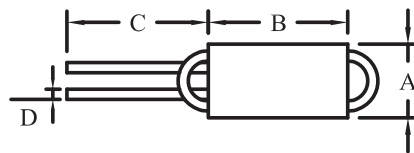

2 Ts

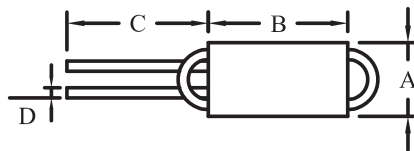

3 Ts

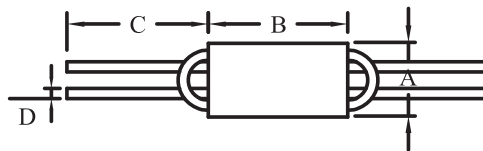

1.5Ts + 1.5 Ts

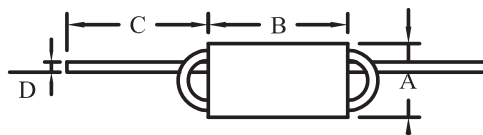

2.5 Ts

Dimension (mm)

Type	∅A ±0.5	B ±0.5	C (min)	∅D ±0.05
EWB R6H□1.5	6.0	10.0	15.0	0.5 / 0.6
EWB R6H□2.5	6.0	10.0	15.0	0.5 / 0.6
EWB R6H□3.0	6.0	10.0	15.0	0.5 / 0.6
EWB R6H□1.5+1.5	6.0	10.0	15.0	0.5 / 0.6

※Design as Customer's Requested Specifications.

※MSL Rating: 2.